

ADD_ON VERTICAL ELECTRIC

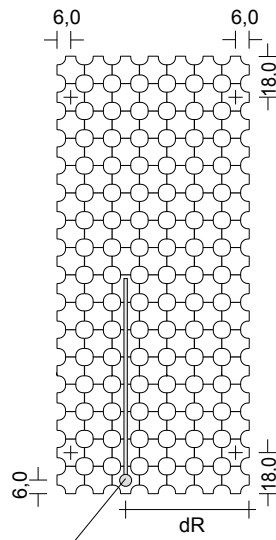

Position of electric heating element

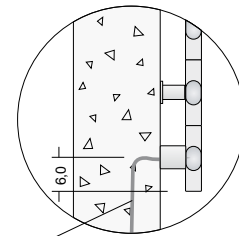
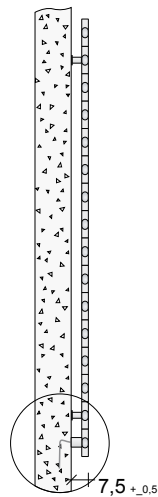

electric heating element supply cable or wireless receiver connection cable to be inserted in a wall-recessed box placed as desired up to 1.20 cm from the Add_On

Add_On electric heating element cable

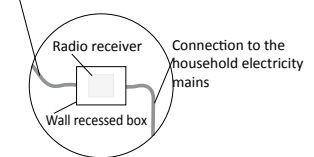

Product code AD_RE#168036901002

AD_RE#168036
9010

Article code specified in the price table
Colour/finish code specified in the Official TUBES COLOUR CHART

ACCESSORIES

ZRF007

Radio frequency WALL room thermostat kit with weekly PROGRAMMER

Height (cm)	120			144			168			192			216			
Code	L (cm)	Electrical Resistance (Watts)	dR (cm)	Price (€)	Electrical Resistance (Watts)	dR (cm)	Price (€)	Electrical Resistance (Watts)	dR (cm)	Price (€)	Electrical Resistance (Watts)	dR (cm)	Price (€)	Electrical Resistance (Watts)	dR (cm)	Price (€)
AD_RE#	36,0	300 W	18		300 W	18		600 W	18		600 W	18		600 W	18	
AD_RE#	48,0	600 W	18		600 W	18		600 W	18		900 W	18		900 W	18	
AD_RE#	60,0	600 W	30		600 W	30		900 W	30		1200 W	30		1200 W	30	
AD_RE#	72,0	600 W	30		900 W	30		1200 W	30		1200 W	30				
AD_RE#	84,0	900 W	42		900 W	42		1200 W	42							
AD_RE#	96,0	900 W	42		1200 W	42										

COLOURS

The ADD_ON model in all its versions is supplied in the Standard White colour (code 9010) as standard and in all the colours specified in the Tubes colour chart without any variation in price. NO GRCC.

ELECTRIC CONTROLS

Electric control is via the use of the ZRF007 thermostat which regulates the room temperature by interacting with up to a maximum of 5 radiators.

 cod. ZRF007	Code	Description	Finishes	Price (€)
	ZRF007	Radio frequency Room Thermostat Kit with weekly programmer for wall mounting, wireless and certified ECODesign. The Kit includes the wall box radio frequency receiver which must strictly be installed.	White	

ADD_ON HORIZONTAL ELECTRIC

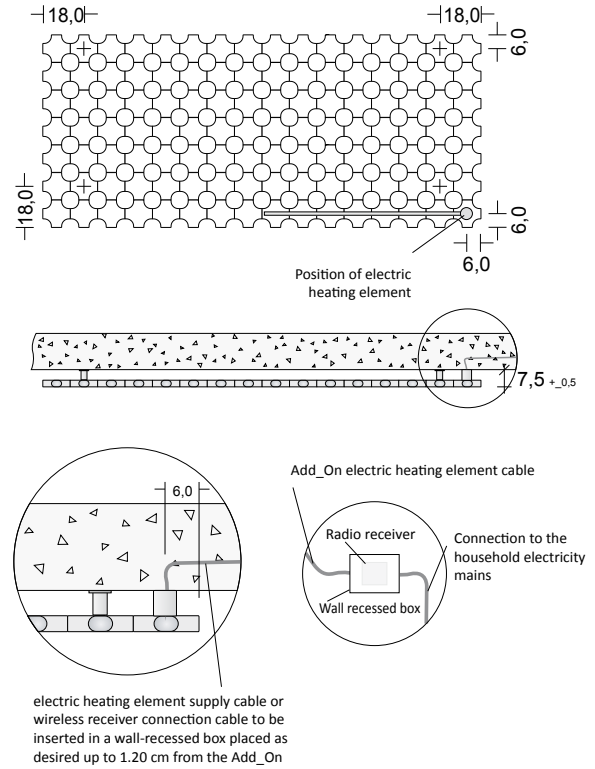

Product code **AD_ROE#168036901002**

AD_ROE#168036 Article code specified in the price table
 9010 Colour/finish code specified in the Official TUBES COLOUR CHART

ACCESSORIES

ZRF007 Radio frequency WALL room thermostat kit with weekly PROGRAMMER

Width (cm)		120			144			168		
Code	H (cm)	Electrical Resistance (Watts)	dR (cm)	Price (€)	Electrical Resistance (Watts)	dR (cm)	Price (€)	Electrical Resistance (Watts)	dR (cm)	Price (€)
AD_ROE#	24,0	300 W	6		600 W	6		300 W	6	
AD_ROE#	36,0	300 W	6		300 W	6		300 W	6	
AD_ROE#	48,0	600 W	6		600 W	6		600 W	6	

ELECTRIC CONTROLS

Electric control is via the use of the ZRF007 thermostat which regulates the room temperature by interacting with up to a maximum of 5 radiators.

	Code	Description	Finishes	Price (€)
	ZRF007	Radio frequency Room Thermostat Kit with weekly programmer for wall mounting, wireless and certified ECOdesign. The Kit includes the wall box radio frequency receiver which must strictly be installed.	White	

Price for Radiator/Towel warmer in Standard White/Chrome color (where specified) and standard connections - VAT and transport excluded.

ADD_ON FREE SHAPE

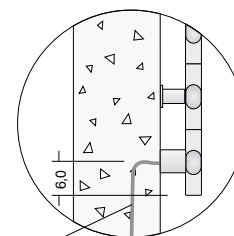
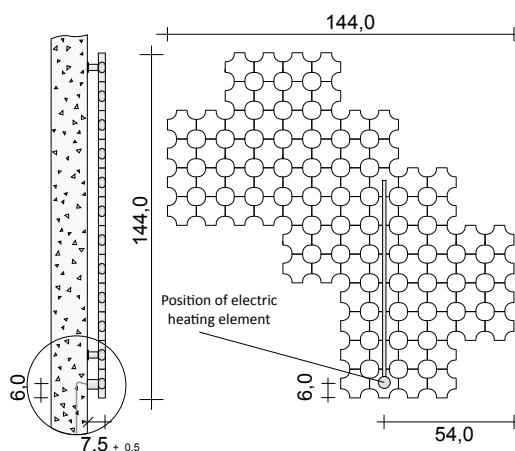

electric heating element supply cable or wireless receiver connection cable to be inserted in a wall-recessed box placed as desired up to 1.20 cm from the Add_On

Add_On electric heating element cable

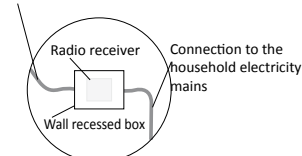

Product code **AD_FE#019010**

AD_FE#019010
9010

Article code specified in the price table
Colour/finish code specified in the Official TUBES COLOUR CHART

ACCESSORIES

ZRF007

Radio frequency WALL room thermostat kit with weekly PROGRAMMER

Code	Description	Watt	Price (€) Finish Ral 9010	Price (€) Finish NELC
AD_FE#01	Add_On Free shape L1 ELECTRIC	900 W		

COLOURS

The ADD_ON model in all its versions is supplied in the Standard White colour (code 9010) as standard and in all the colours specified in the Tubes colour chart without any variation in price. NO GRCCR.

ELECTRIC CONTROLS

Electric control is via the use of the ZRF007 thermostat which regulates the room temperature by interacting with up to a maximum of 5 radiators.

Code	Description	Finishes	Price (€)
ZRF007	Radio frequency Room Thermostat Kit with weekly programmer for wall mounting, wireless and certified ECDesign. The Kit includes the wall box radio frequency receiver which must strictly be installed.	White	

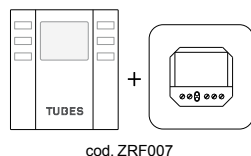



ADD_ON VERTICAL

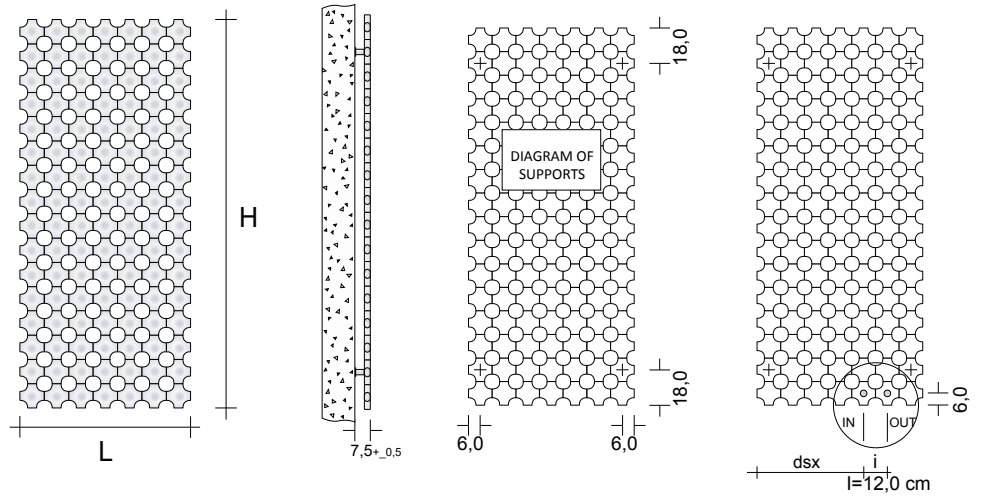

CONNECTORS POSITIONING

Connection of the radiator to the system is via Remote Valve Assembly GVR and the interaxial distance of the connectors on the radiator is shown in the diagram below

dsx = distance from the Left side of the radiator and the centre of the first connector variable according to the width of the radiator, see table below

- dsx** = 6 cm for L. 24 cm
- dsx** = 18 cm for L. 36 and 48 cm
- dsx** = 30 cm for L. 60 and 72 cm
- dsx** = 42 cm for L. 84 and 96 cm

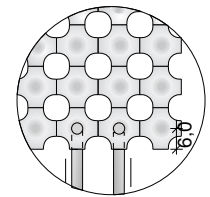

RADIATOR connection to GVR

ADD_ON HORIZONTAL

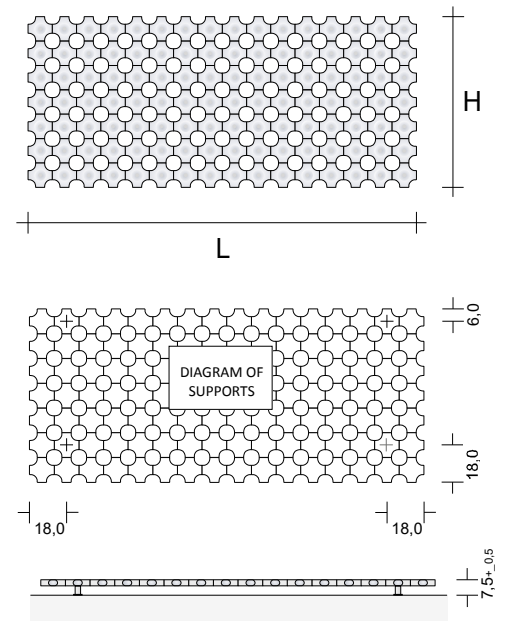

CONNECTORS POSITIONING

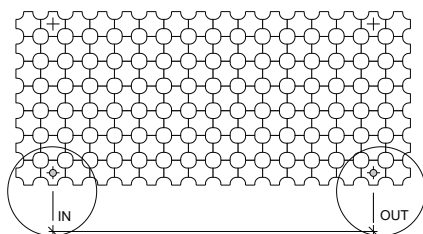

I = L - 36,0 cm

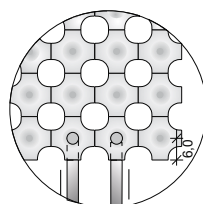

RADIATOR connection to GVR

The ADD_ON model is connected to the central heating system with the remote connection GVR_AD (Valve Assembly for ADD_ON) supplied as an accessory

Product code **AD_R#192048ST9010-AD_RO#192048ST9010**

AD_R#192048-AD_RO#192048 Article code specified in the price table
 ST Standard support code
 9010 Colour/finish code specified in the Official TUBES COLOUR CHART

VERTICAL

Height (cm)	120			144			168			192			216			240			
Code	L (cm)	Watt ΔT. 50°C	Watt ΔT. 30°C	Price (€)	Watt ΔT. 50°C	Watt ΔT. 30°C	Price (€)	Watt ΔT. 50°C	Watt ΔT. 30°C	Price (€)	Watt ΔT. 50°C	Watt ΔT. 30°C	Price (€)	Watt ΔT. 50°C	Watt ΔT. 30°C	Price (€)	Watt ΔT. 50°C	Watt ΔT. 30°C	Price (€)
AD_R#	24,0	273	143		329	175		386	209		443	238		501	272		559	307	
AD_R#	36,0	410	214		494	263		579	313		665	357		752	408		839	460	
AD_R#	48,0	534	279		644	342		754	408		866	465		979	531		1093	600	
AD_R#	60,0	651	341		785	417		920	497		1057	567		1195	649		1334	732	
AD_R#	72,0	762	399		919	489		1077	582		1237	664		1399	759		1562	857	
AD_R#	84,0	866	453		1045	556		1225	662		1407	755		1591	864		1777	975	
AD_R#	96,0	964	504		1163	618		1364	737		1567	841		1772	962		1979	1086	

HORIZONTAL

Width (cm)	120			144			168			192			216			240			
Code	H (cm)	Watt ΔT. 50°C	Watt ΔT. 30°C	Price (€)	Watt ΔT. 50°C	Watt ΔT. 30°C	Price (€)	Watt ΔT. 50°C	Watt ΔT. 30°C	Price (€)	Watt ΔT. 50°C	Watt ΔT. 30°C	Price (€)	Watt ΔT. 50°C	Watt ΔT. 30°C	Price (€)	Watt ΔT. 50°C	Watt ΔT. 30°C	Price (€)
AD_RO#	24,0	273	143		329	175		386	209		443	230		501	272		559	307	
AD_RO#	36,0	410	214		494	263		579	313		665	357		752	408		839	460	
AD_RO#	48,0	534	279		644	342		754	408		866	465		979	531		1093	600	
AD_RO#	60,0	651	341		785	417		920	497		1057	567		1195	649		1334	732	
AD_RO#	72,0	762	399		919	489		1077	582		1237	664		1399	759		1562	857	
AD_RO#	84,0	866	453		1045	556		1225	662		1407	755		1591	864		1777	975	
AD_RO#	96,0	964	504		1163	618		1364	737		1567	841		1772	962		1979	1086	

COLOURS

The ADD_ON model in all its versions is supplied in the Standard White colour (code 9010) as standard and in all the colours specified in the Tubes colour chart without any variation in price. NO GRGR

PACKING

The cardboard packaging is included in the selling price of the products and provides the kit for fixing to the wall and the manual vent valve.

REMOTE VALVE ASSEMBLY FOR ADD_ON (GVR_AD)

The GVR_AD includes the remote connection valve and lockshield assembly, customized for the Add_On model. It can be installed up to a maximum of 6 mt. from the radiator.

GVR connection to the hydraulic system

	Code	Description	Finishes	Price (€)
	GVR_AD#9010	Remote valve group for ADD_ON Tubes Standard White finish	Glossy White	

FRONT VIEW

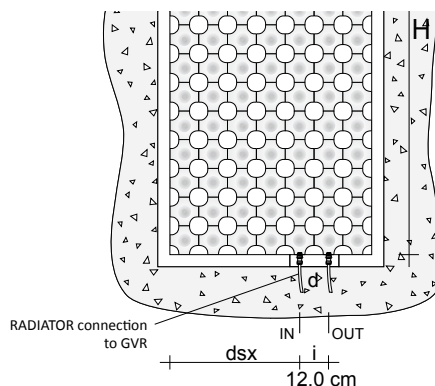

LONGITUDINAL CROSS-SECTIONS

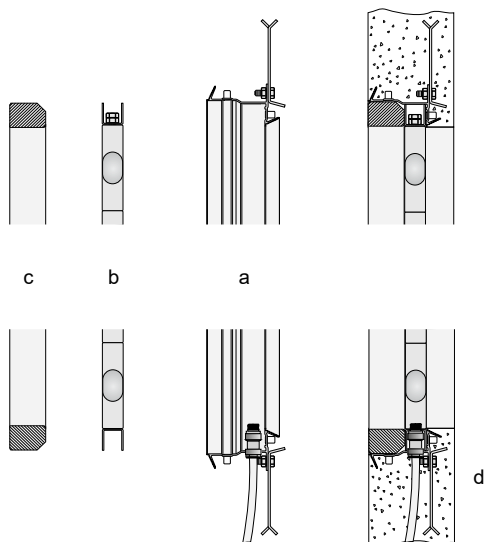

- a Counterframe to be walled supplied with Add_On in-wall
- b Frame installed on Add_On for installation on the counterframe
- c UNFINISHED MDF frame for securing, to be painted or plastered
- d Space reserved for the hydraulic connection to the central heating system

CONNECTORS POSITIONING

Connection of the radiator to the system is via Remote Valve Assembly GVR and the interaxis of the connectors on the radiator is shown in the diagram below

dsx = distance from the Left side of the radiator and the centre of the first connector variable according to the width of the radiator, see table below

dsx = 6 cm for L. 24 cm

dsx = 18 cm for L. 36 and 48 cm

dsx = 30 cm for L. 60 and 72 cm

dsx = 42 cm for L. 84 and 96 cm

Notes on mounting Add_On in-wall

- 1 Counterframe (a) installation in the unfinished brickwork following the assembly instructions provided in the pack
- 2 Prepare the connection to the central heating system (d)
- 3 Install the Add_On complete with the frame (b) in the counterframe (a)
- 4 Connect Add_On to the central heating system through the set-up (d)
- 5 Install the MDF (c) frame for covering and securing Add_On in-wall
- 6 Paint or plaster the MDF © frame with the same finish as the wall

Product code **AD_RI#192048ST9010**

AD_RI#192048	Article code specified in the price table
ST	Standard support code
9010	Colour/finish code specified in the Official TUBES COLOUR CHART

ADD_ON INTRAMURO VERTICAL

Height (cm)	120			144			168			192			216			240			
Code	L (cm)	Watt $\Delta T. 50^{\circ}C$	Watt $\Delta T. 30^{\circ}C$	Price (€)	Watt $\Delta T. 50^{\circ}C$	Watt $\Delta T. 30^{\circ}C$	Price (€)	Watt $\Delta T. 50^{\circ}C$	Watt $\Delta T. 30^{\circ}C$	Price (€)	Watt $\Delta T. 50^{\circ}C$	Watt $\Delta T. 30^{\circ}C$	Price (€)	Watt $\Delta T. 50^{\circ}C$	Watt $\Delta T. 30^{\circ}C$	Price (€)	Watt $\Delta T. 50^{\circ}C$	Watt $\Delta T. 30^{\circ}C$	Price (€)
AD_RI#	36,0	410	214		494	263		579	313		665	357		752	408		839	460	
AD_RI#	48,0	534	279		644	342		754	408		866	465		979	531		1093	600	
AD_RI#	60,0	651	341		785	417		920	497		1057	567		1195	649		1334	732	
AD_RI#	72,0	762	399		919	489		1077	582		1237	664		1399	759		1562	857	
AD_RI#	84,0	866	453		1045	556		1225	662		1407	755		1591	864		1777	975	
AD_RI#	96,0	964	504		1163	618		1364	737		1567	841		1772	962		1979	1086	

corresponding RECESSED PART

Height (cm)	120		144		168		192		216		240	
Code	L (cm)	Price (€)	Price (€)	Price (€)	Price (€)	Price (€)	Price (€)	Price (€)	Price (€)	Price (€)	Price (€)	
INTRA_AD#	36,0											
INTRA_AD#	48,0											
INTRA_AD#	60,0											
INTRA_AD#	72,0											
INTRA_AD#	84,0											
INTRA_AD#	96,0											

REMOTE VALVE ASSEMBLY FOR ADD_ON (GVR_AD)

The GVR_AD includes the remote connection valve and lockshield assembly, customized for the Add_On model. It can be installed up to a maximum of 6 mt. from the radiator.

GVR connection to the hydraulic system

	Code	Description	Finishes	Price (€)
	GVR_AD#9010	Remote valve group for ADD_ON Tubes Standard White finish	Glossy White	

FRONT VIEW



LONGITUDINAL CROSS-SECTIONS

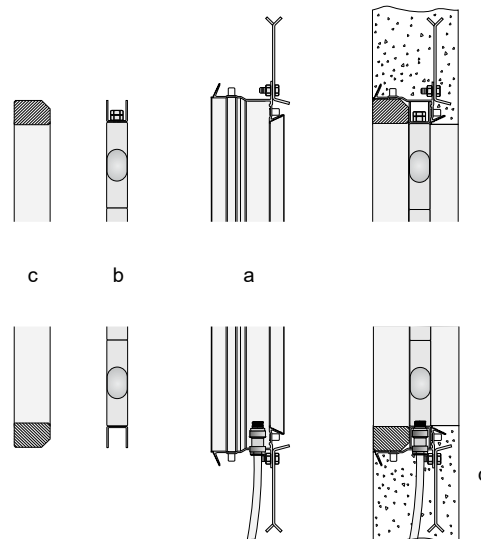
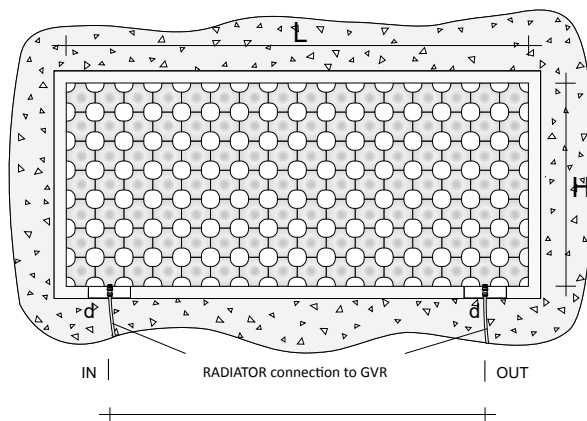

Counterframe to be walled in supplied together with the Add_On in-wall
 b Frame installed on the Add_On for installation in counterframe
 c UNFINISHED MDF frame for securing, to be painted or plastered
 d Space reserved for the hydraulic connection to the central heating system

Notes on Add_On in-wall assembly

- 1 Counterframe (a) installation in the unfinished brickwork following the assembly instructions provided in the pack
- 2 Set up the connection to the central heating system (d)
- 3 Install the Add_On complete with frame (b) in the counterframe (a)
- 4 Connect the Add_On to the central heating system thanks to the set-up (d)
- 5 Install the MDF (c) frame for covering and securing Add_On In-wall
- 6 Paint or plaster the MDF © frame with the same finish as the wall

Product code **AD_ROI#168048ST9010**

AD_ROI#168048	Article code specified in the price table
ST	Standard support code
9010	Colour/finish code specified in the Official TUBES COLOUR CHART

ADD_ON INTRAMURO HORIZONTAL

Width (cm)	120			144			168			192			216			240			
Code	H (cm)	Watt $\Delta T. 50^{\circ}C$	Watt $\Delta T. 30^{\circ}C$	Price (€)	Watt $\Delta T. 50^{\circ}C$	Watt $\Delta T. 30^{\circ}C$	Price (€)	Watt $\Delta T. 50^{\circ}C$	Watt $\Delta T. 30^{\circ}C$	Price (€)	Watt $\Delta T. 50^{\circ}C$	Watt $\Delta T. 30^{\circ}C$	Price (€)	Watt $\Delta T. 50^{\circ}C$	Watt $\Delta T. 30^{\circ}C$	Price (€)	Watt $\Delta T. 50^{\circ}C$	Watt $\Delta T. 30^{\circ}C$	Price (€)
AD_ROI#	36,0	410	214		494	263		579	313		665	357		752	408		839	460	
AD_ROI#	48,0	534	279		644	342		754	408		866	465		979	531		1093	600	
AD_ROI#	60,0	651	341		785	417		920	497		1057	567		1195	649		1334	732	
AD_ROI#	72,0	762	399		919	489		1077	582		1237	664		1399	759		1562	857	
AD_ROI#	84,0	866	453		1045	556		1225	662		1407	755		1591	864		1777	975	
AD_ROI#	96,0	964	504		1163	618		1364	737		1567	841		1772	962		1979	1086	

corresponding RECESSED PART

Width (cm)	120		144		168		192		216		240	
Code	H (cm)	Price (€)	Price (€)	Price (€)	Price (€)	Price (€)	Price (€)	Price (€)	Price (€)	Price (€)	Price (€)	
INTRA_ADO#	36,0											
INTRA_ADO#	48,0											
INTRA_ADO#	60,0											
INTRA_ADO#	72,0											
INTRA_ADO#	84,0											
INTRA_ADO#	96,0											

REMOTE VALVE ASSEMBLY FOR ADD_ON (GVR_AD)

The GVR_AD includes the remote connection valve and lockshield assembly, customized for the Add_On model. It can be installed up to a maximum of 6 mt. from the radiator.

GVR connection to the hydraulic system

	Code	Description	Finishes	Price (€)
	GVR_AD#9010	Remote valve group for ADD_ON Tubes Standard White finish	Glossy White	

ADD_ON MODEL L1

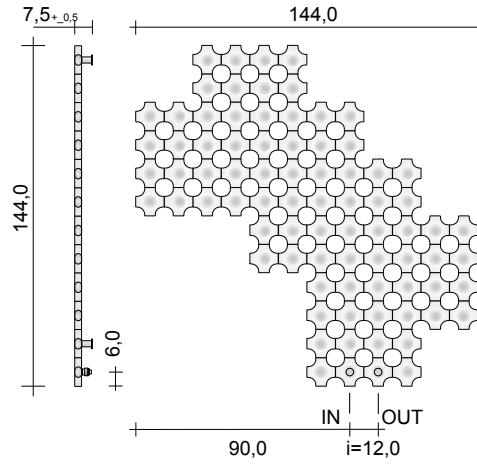

ADD_ON MODEL L4

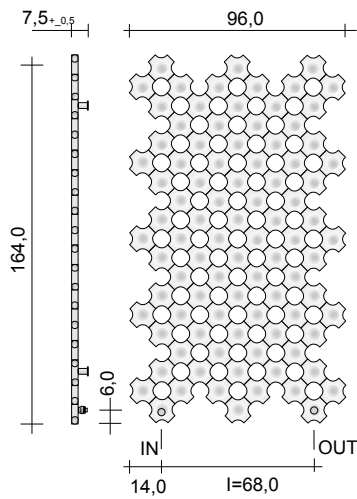

Product code **AD_F#01ST9010**

AD_F#01	Article code specified in the price table
ST	Standard support code
9010	Colour/finish code specified in the Official TUBES COLOUR CHART

Model	H (cm)	L (cm)	Heat output in Watts COLOURED version		Price Standard White Cat. C0 (€)	Price Category C1/C2 (€)	Price Category Cat. C3 (€)
			$\Delta T. 50^{\circ}C$	$\Delta T. 30^{\circ}C$			
AD_F#01	144,0	144,0	969	515			
AD_F#04	164,0	96,0	1120	605			

REMOTE VALVE ASSEMBLY FOR ADD_ON (GVR_AD)

The GVR_AD includes the remote connection valve and lockshield assembly, customized for the Add_On model. It can be installed up to a maximum of 6 mt. from the radiator.

GVR connection to the hydraulic system

	Code	Description	Finishes	Price (€)
		GVR_AD#9010	Remote valve group for ADD_ON Tubes Standard White finish	Glossy White